



# EZFIT WOODSMAN INSTRUCTION MANUAL

- **Thank-you for purchasing an EZ-Fit Shed!** Our goal is to provide you with everything you need to make the assembly of your shed kit go smoothly.
- **This instruction manual is based on a 10x14' EZFIT WOODSMAN shed kit.**  
Your shed kit may be a different size - if this is the case you will have a different amount of wall panels and roof sheathing, however the same assembly methods apply. There is paperwork included with your packing slip that shows the details on the wall panels and roof sheathing included for your particular shed kit.
- **This manual includes assembly instructions for the optional floor kit.**  
If you purchased your own flooring materials elsewhere, you may refer to this section for tips on assembly. If you are using concrete for your floor, simply disregard this part of the instructions.
- **Your packing list is included with the shed kit.** The packing list includes a detailed layout of your wall panels and roof sheathing. The packing list also includes a complete list of all items in your package, including a list of fasteners.
- **Basic list of included fasteners:**

## 2" Nails:

Fastening 3/4" flooring to floor joists (optional floor kit.)  
Corner trim  
Roof sheathing  
Roof gussets  
Fastening Smartside Soffit to sidewalls  
Fastening rafters to soffit  
Facia trim  
Windows and window trim.

## Tools Needed:

- Cordless Drill
- Tape Measure
- Step-ladder
- Skilsaw
- Chalkline
- Speed Square
- Level
- Hammer

## 2.5" Square-Drive Screws:

Fastening wall panels together  
Double 2x4" top/plates  
Fastening bottom/plate of walls down into floor. (once building is assembled)

**2.5" Black Screws:** for door hardware



# FLOOR CONSTRUCTION

Top View of floor framing

To make that floor is square:  
Measure diagonally across corners and  
make that both measurements are same.

Top View of  
LP ProStruct Flooring

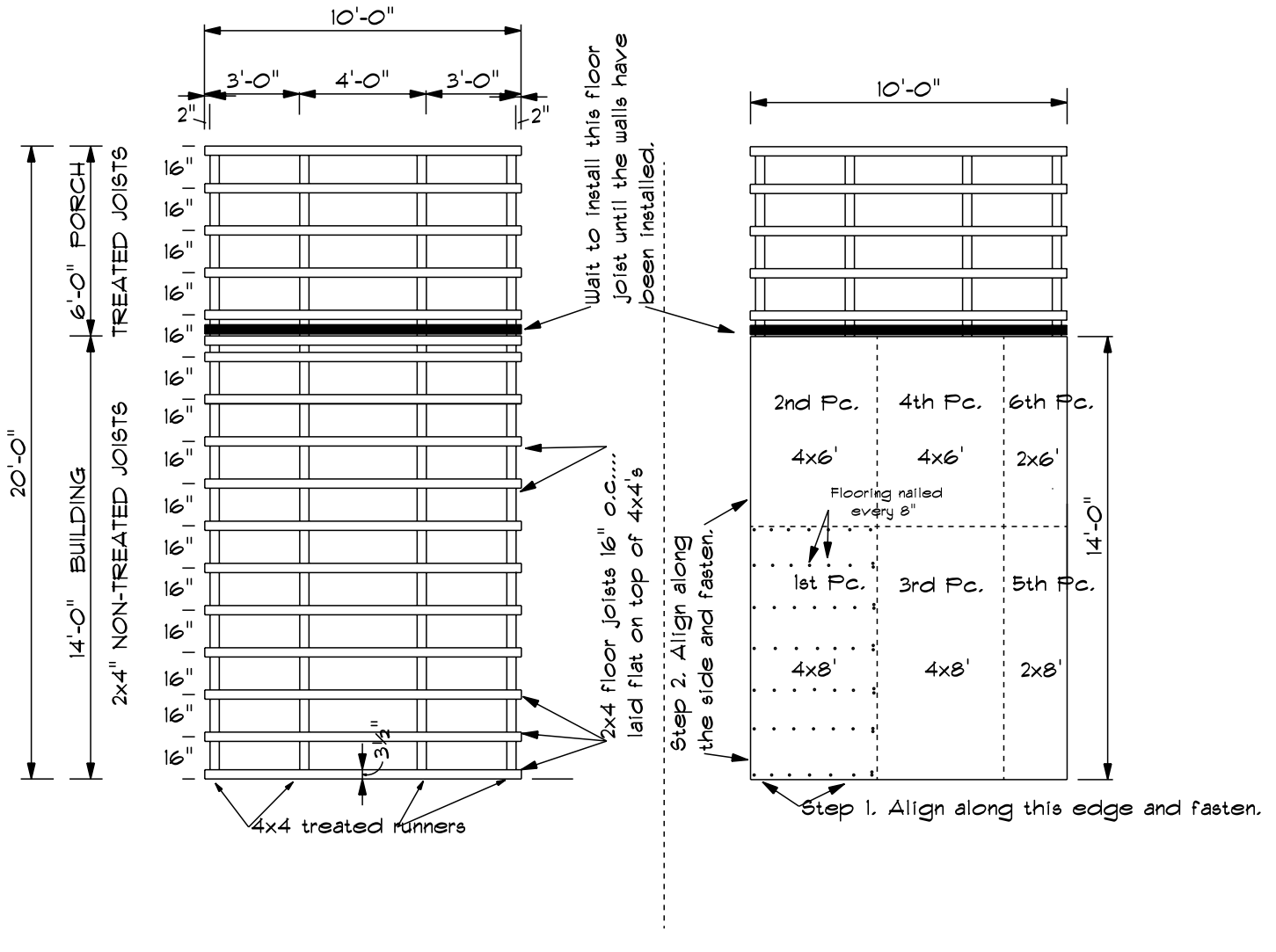

Front View

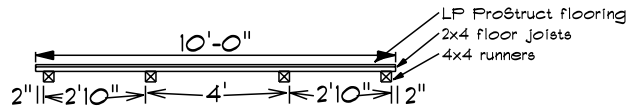

## 01 FLOOR

SCALE: 3/16" = 1'-0"

SIDE VIEW - SIDEWALLS 1.

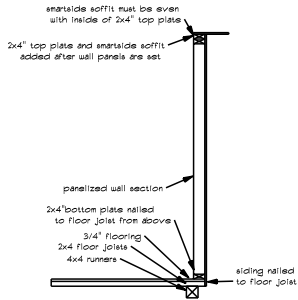

INSIDE VIEW - SIDEWALLS 2.

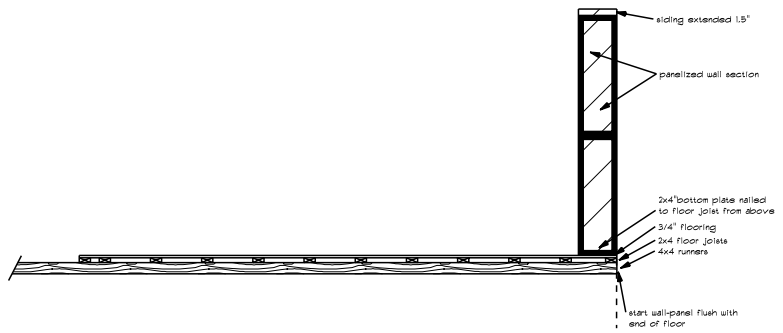

PAGE 2.

INSIDE VIEW - SIDEWALLS 3.

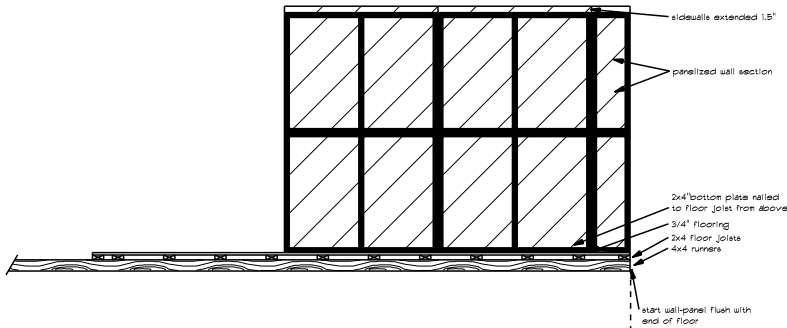

INSIDE VIEW - SIDEWALLS 4.

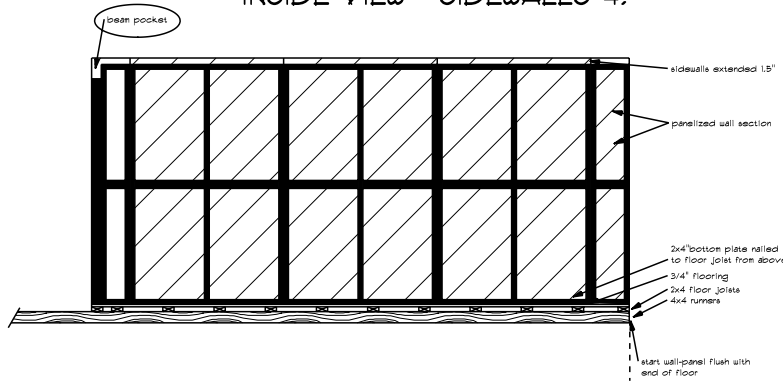

INSIDE VIEW - SIDEWALLS 5.

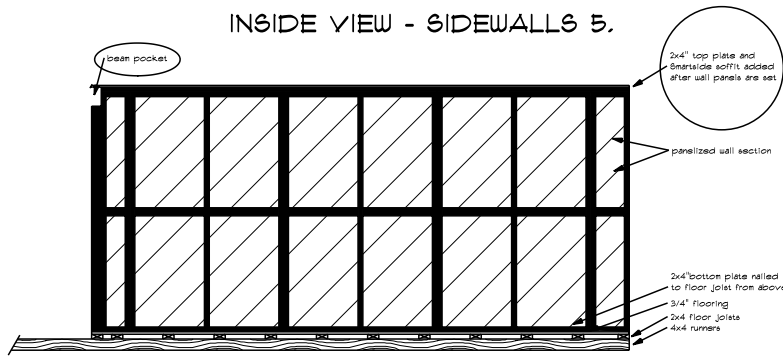

# O2 WALL SIDE

SCALE: 1" = 5'-0"

Note: This is only an example of a 10x14' building.  
 Your particular building size may have different sized wall panels.  
 Refer to the paperwork included with your packing list for more details.

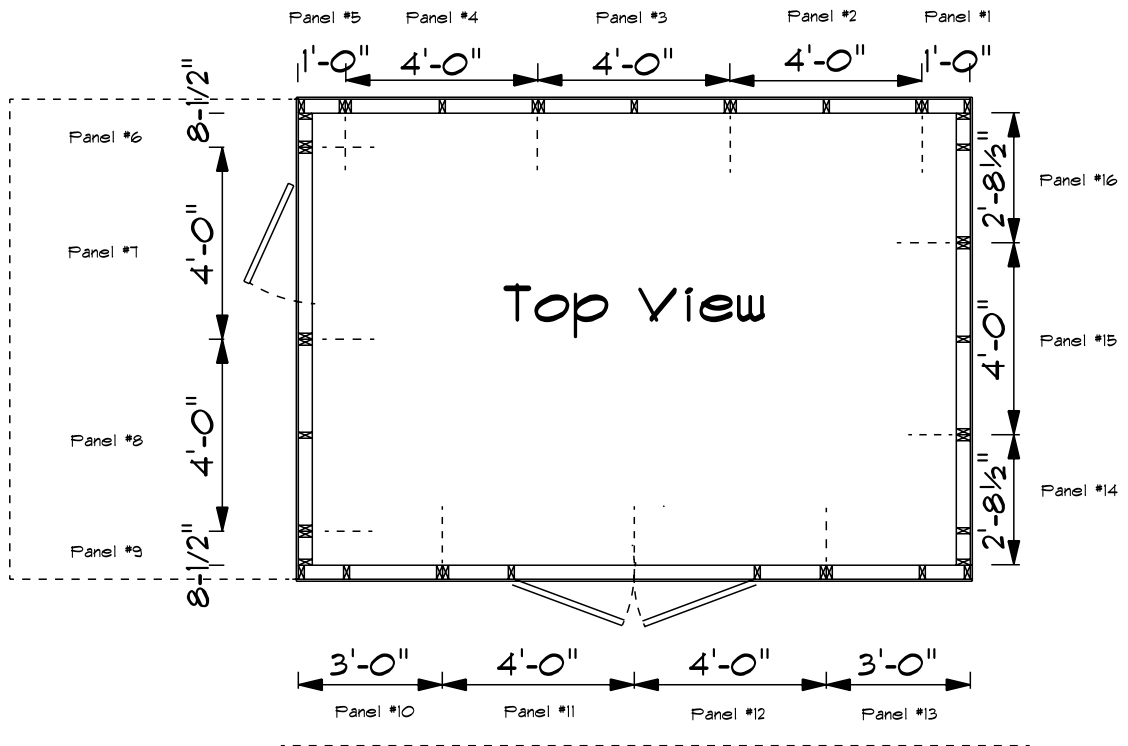

Top View - 2x4" Top/Plates

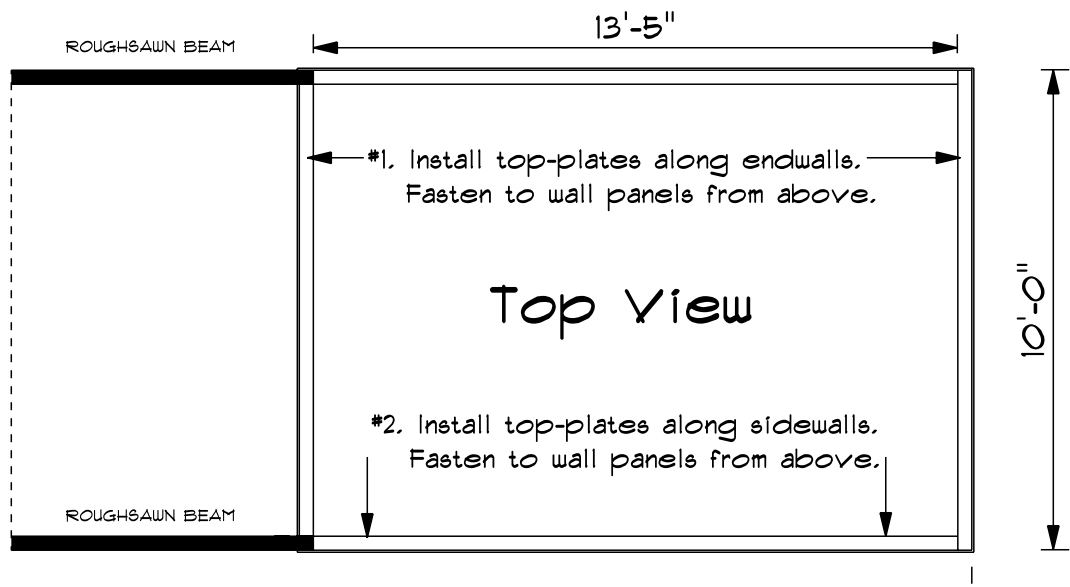

# O3 WALLS TOP VIEW

SCALE: 1/4" = 1'-0"

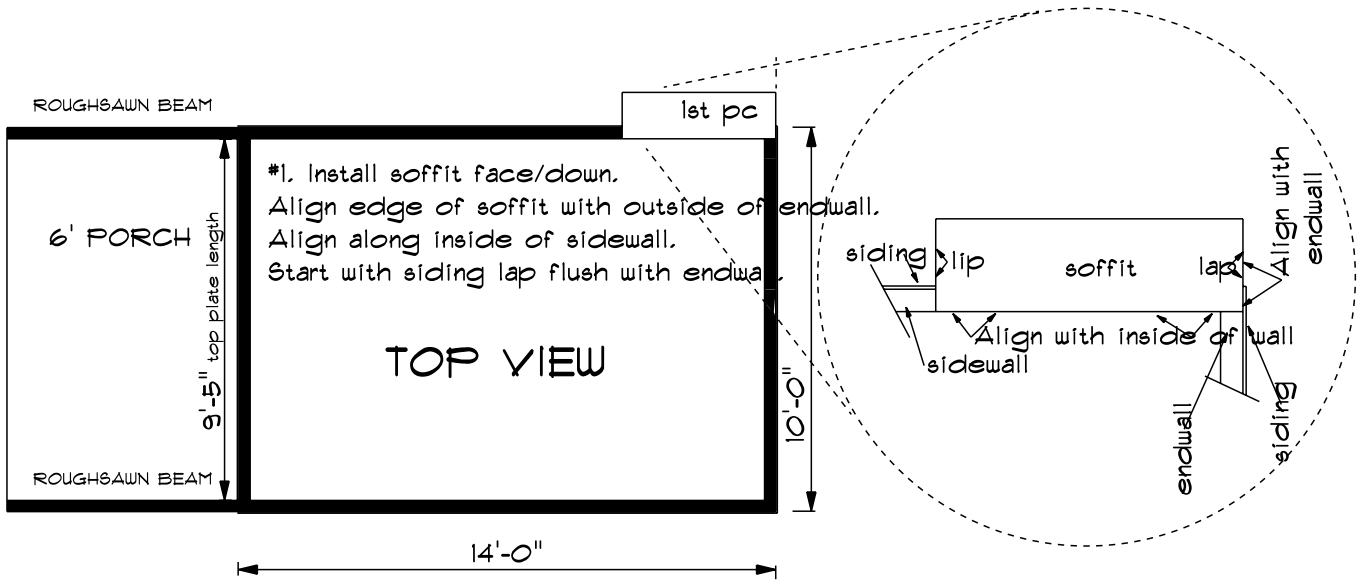

TOP VIEW - SMARTSIDE SOFFIT 2.

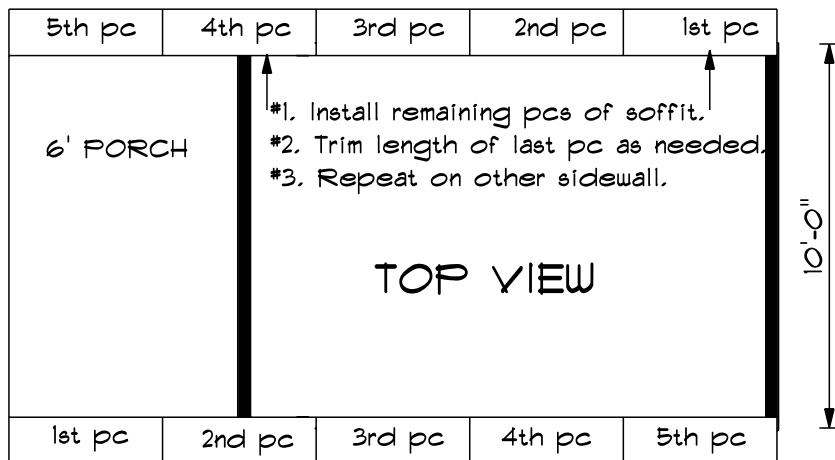

# 04 WALLS SMARTSIDE SOFFIT

SCALE: 1" = 5'-0"

Top view of floor

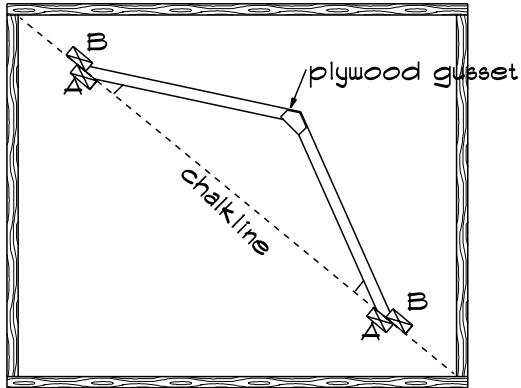

- #1... snap a chalk-line across the corners of floor.
- #2...put 2 stops along bottom of chalk-line ( stop "A")
- #3...measure correct distance for overall width of rafter and put down stops "B".
- #4... match up peak of rafters and fasten gussets.

NOTE: Porch rafters have different shaped gussets to accommodate the porch ceiling.

Overall width of rafter for EZFIT WOODSMAN:

- 8' wide building: 9'10"
- 10' wide building: 11'10"
- 12' wide building: 13'10"

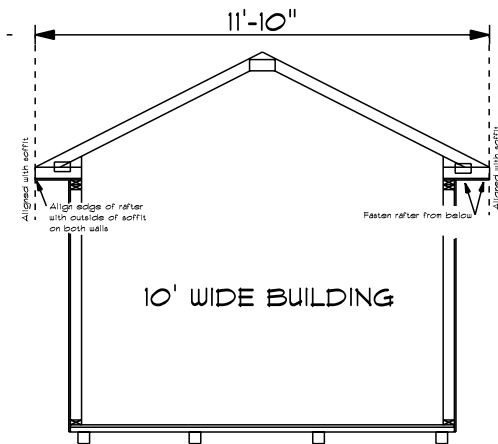

- #1... fasten both gables first.
- NOTE: both gables come in 2 sections with siding already installed.
- #2...make sure both sidewalls are straight and brace walls from inside as needed.
- #3... fasten remainder of rafters as shown

Rafters - Side View

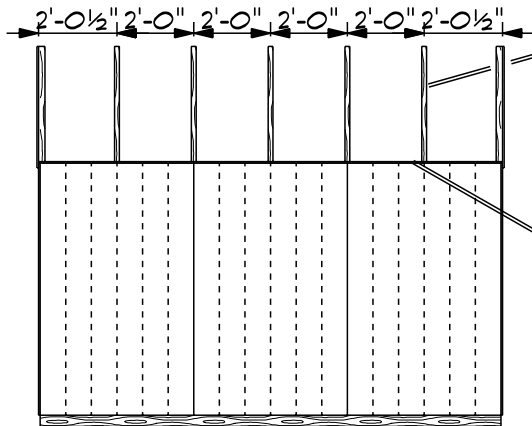

Close-up View

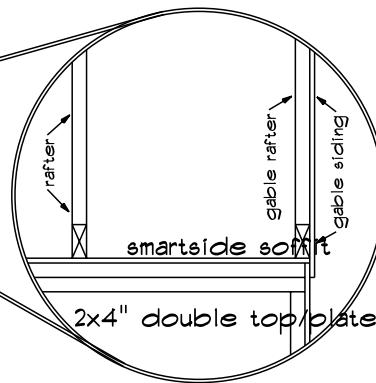

# 05 RAFTER ASSEMBLY

SCALE: 1" = 5'-0"

# GABLE-END INSTALLATION

## End View

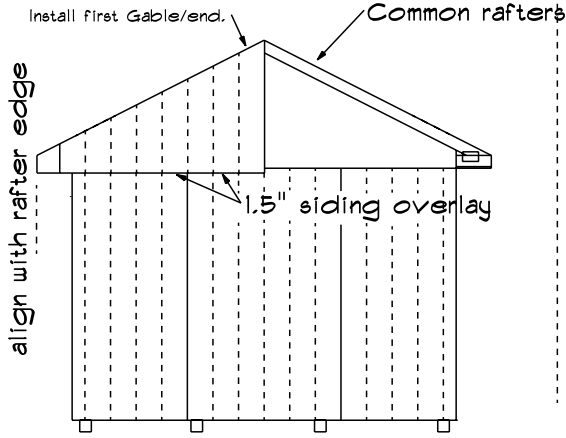

## Side view

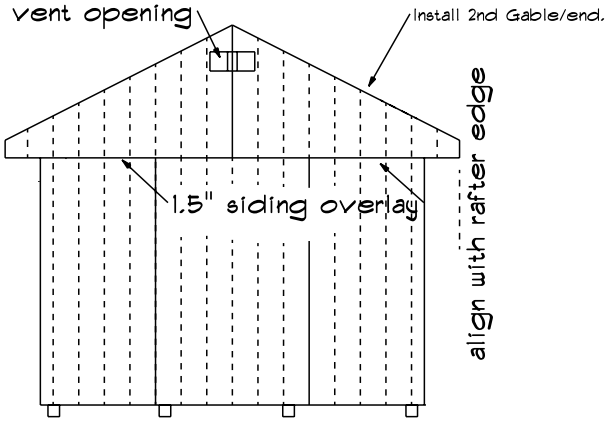
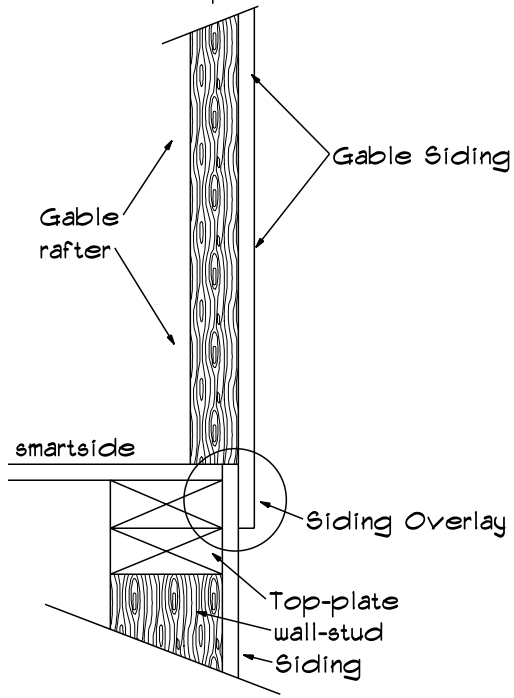

# 06 GABLE END SIDING

SCALE: 1" = 5'-0"

1.

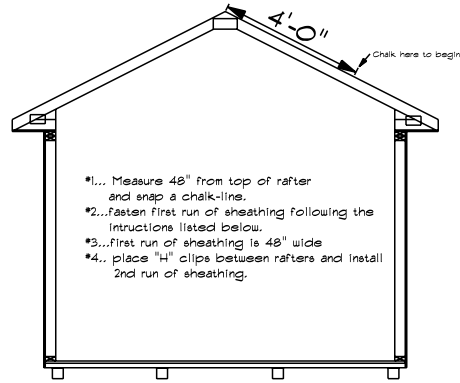

- \*1... Measure 48" from top of rafter and snap a chalk-line.
- \*2...fasten first run of sheathing following the instructions listed below.
- \*3...first run of sheathing is 48" wide
- \*4... place "H" clips between rafters and install 2nd run of sheathing.

2.

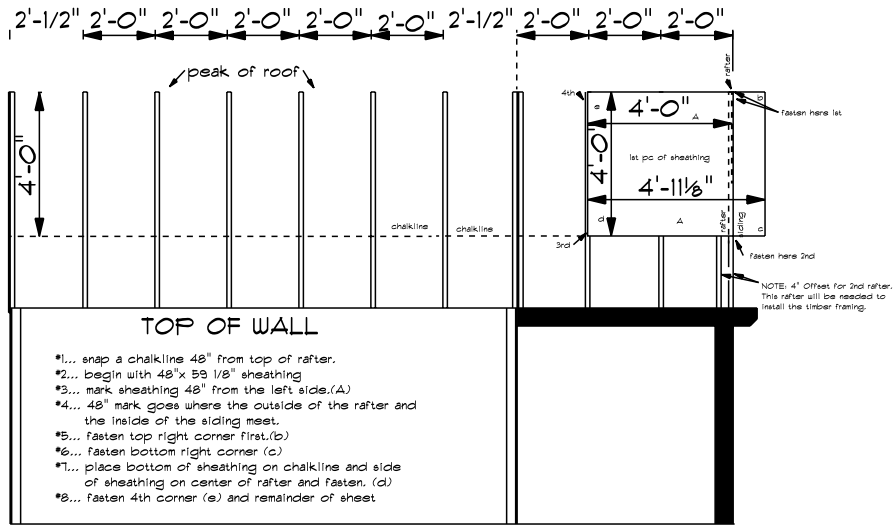

3.

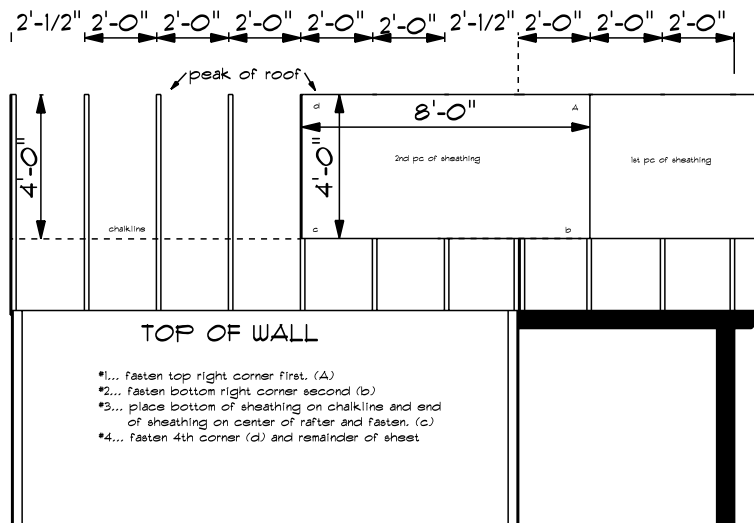

## OT ROOF SHEATHING 1

SCALE: 3/16" = 1'-0"



4.

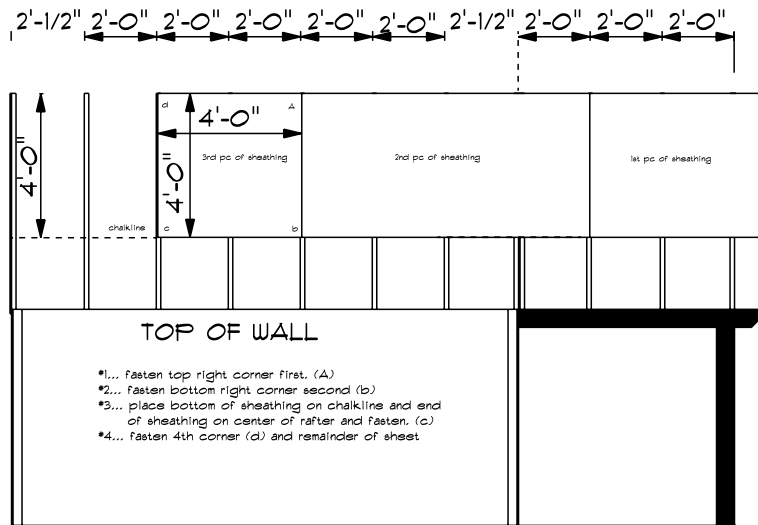

5.

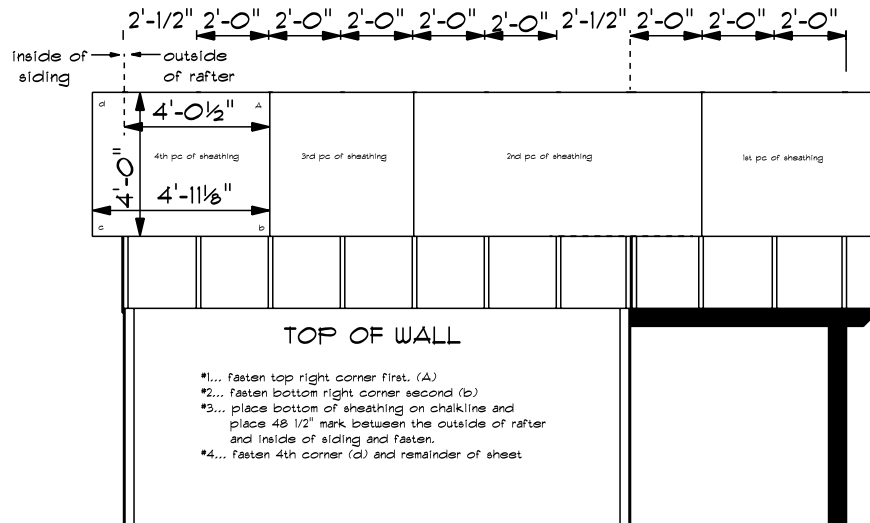

6.

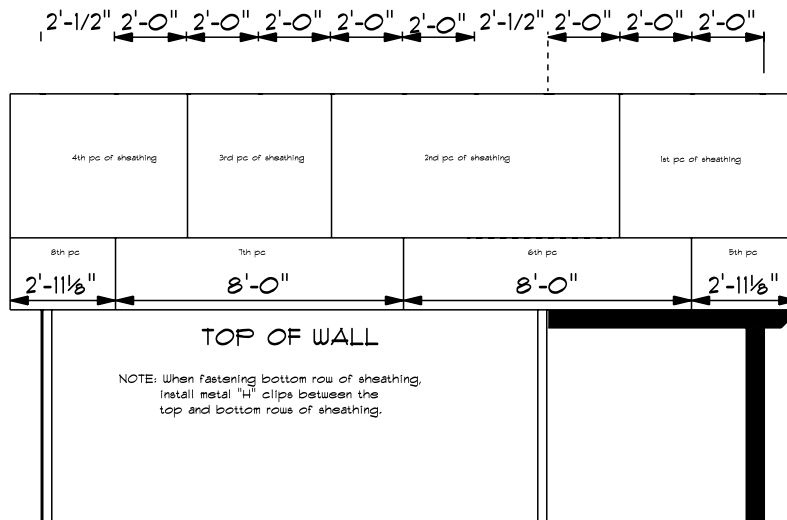

## 08 ROOF SHEATHING 2

SCALE: 3/16" = 1'-0"

ROOF TRIM 1.

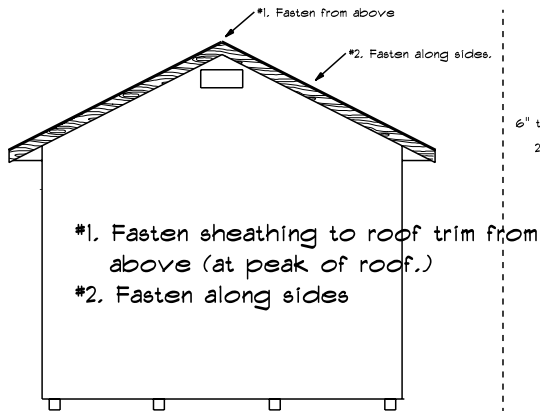

ROOF TRIM 2.

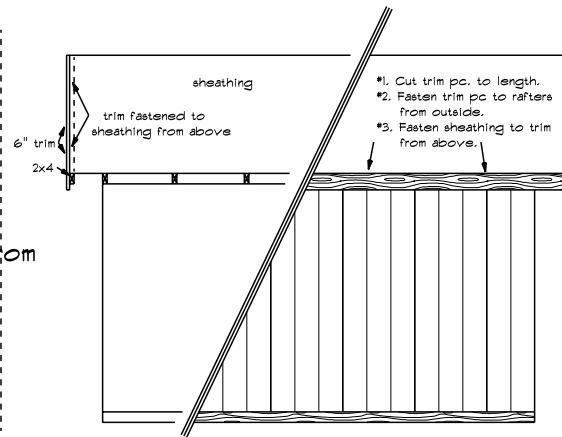

- #1. Install corner trim
- #2. Install windows & shutters  
NOTE: be sure to caulk both behind window & above top window trim piece.
- #3. Install door lockset and springloaded barrel bolts.

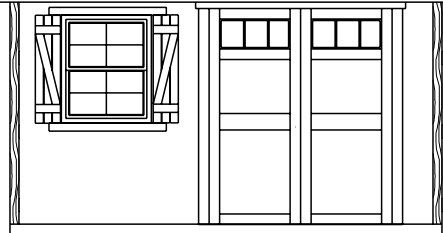

Your building is now ready to be shingled and painted. We recommend using aluminum dripedge along the roof edges.

**ON THE INSIDE:**

Fasten the wall/panel bottom plates to the floor joists. (nailing down thru the LP ProStruct flooring.)  
Nail the wall framing at together at each corner.  
Cut out the 2x4"s in the bottom of the door opening. (these aren't needed.)

**ON THE DOOR:**

Be sure the 2x4x60" header is fastened to the top of the door opening. (actual door opening should be 72" tall x 60" wide.)

## 09 ROOF SHEATHING AND MISC

SCALE: 3/16" = 1'-0"

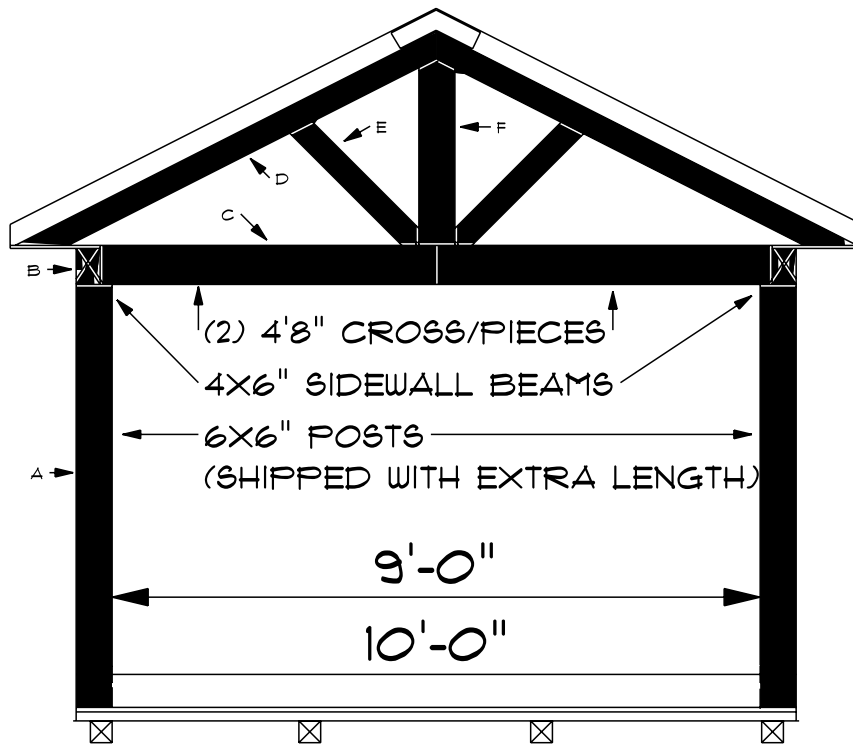

INSTALL: A. posts, B. sidewall beams and C. Cross-pieces before Smartside top/plate and rafters are installed.

WAIT TO INSTALL: D, E and F pcs until the roof sheathing and porch ceiling are installed.

Posts will need to be trimmed to correct length. The rest of the timber framing might need slight trimming but should be very close to the proper length.

SIMPSON STRONGTIE Metal brackets and decorative screws are included for the center of the timberframe.

## 10 TIMBER FRAMING

SCALE: 3/8" = 1'-0"

# ROOF SHEATHING LAYOUT - TOP VIEW

8x8' WITHOUT FLOOR KIT

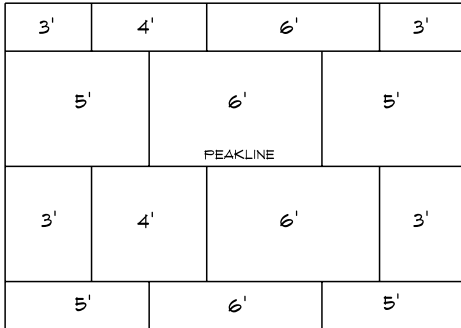

18.5" WIDTH

48" WIDTH

48" WIDTH

18.5" WIDTH

8x12' WITHOUT FLOOR KIT

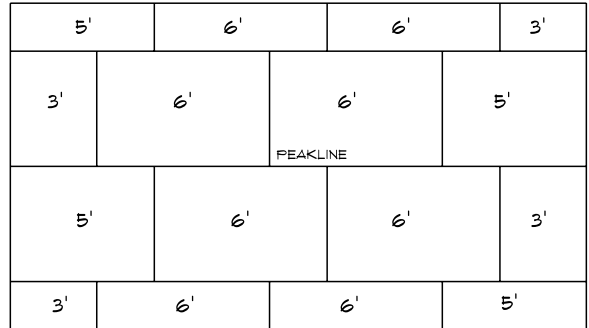

10x10' WITHOUT FLOOR KIT

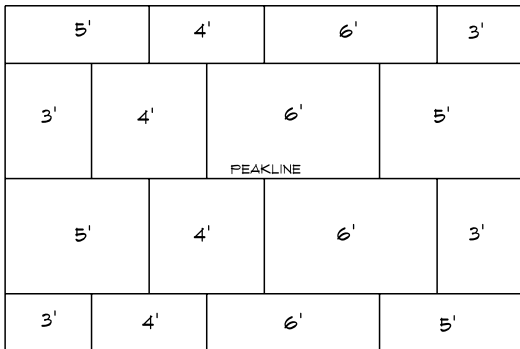

32" WIDTH

48" WIDTH

48" WIDTH

32" WIDTH

10x12' WITHOUT FLOOR KIT

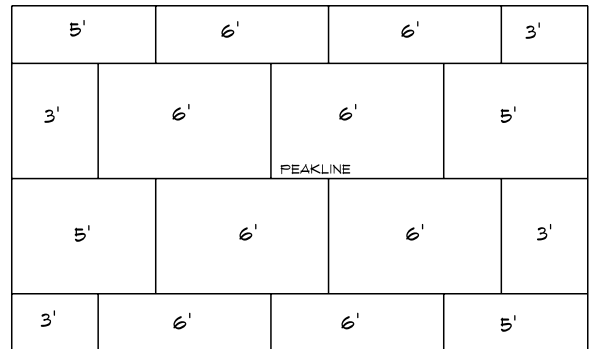

10x14' QUICKSHIP

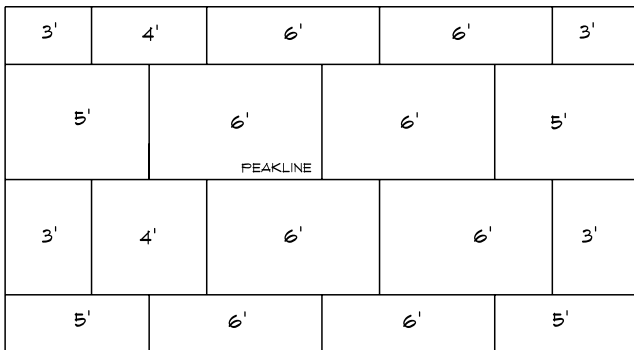

10x16' WITHOUT FLOOR KIT

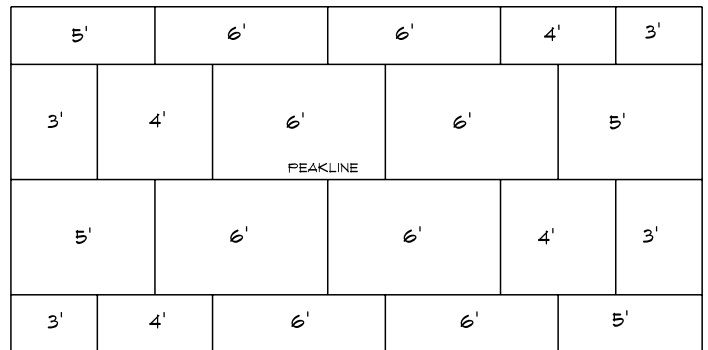

# 11 ROOF SHEATHING LAYOUT

SCALE: 0.1500" = 1'-0"

# ROOF SHEATHING LAYOUT - TOP VIEW

8x8' WITH FLOOR KIT

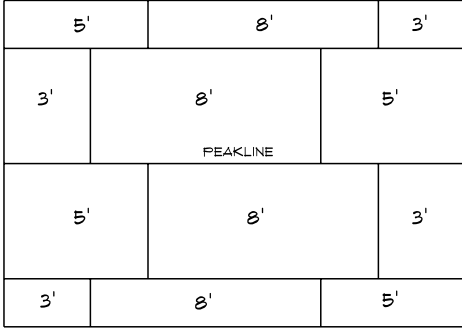

18.5" WIDTH  
48" WIDTH  
48" WIDTH  
18.5" WIDTH

8x12' WITH FLOOR KIT

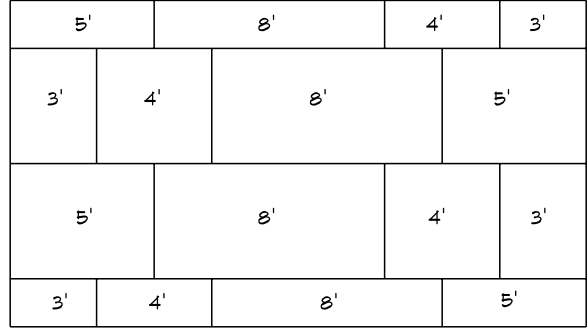

10x10' WITH FLOOR KIT

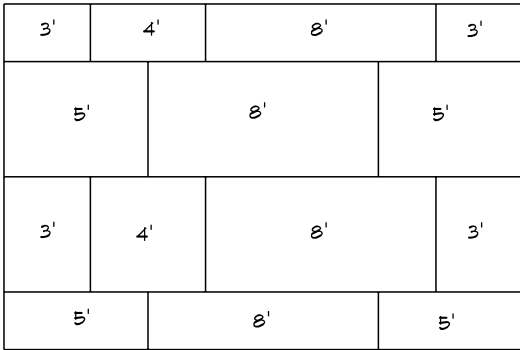

32" WIDTH  
48" WIDTH  
48" WIDTH  
32" WIDTH

10x12' WITH FLOOR KIT

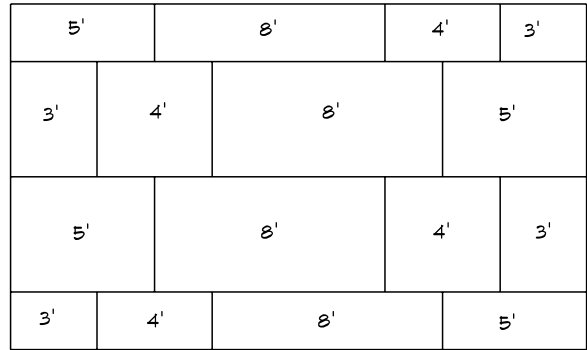

10x14' WITH FLOOR KIT

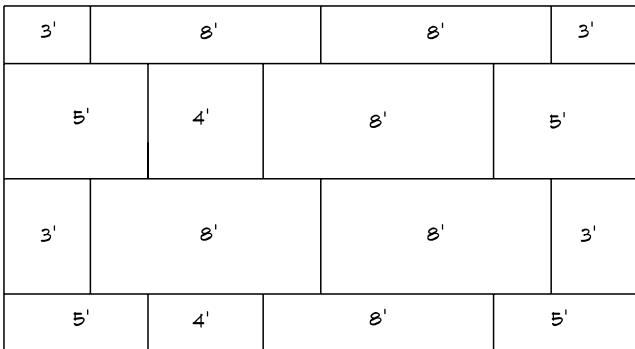

10x16' WITH FLOOR KIT

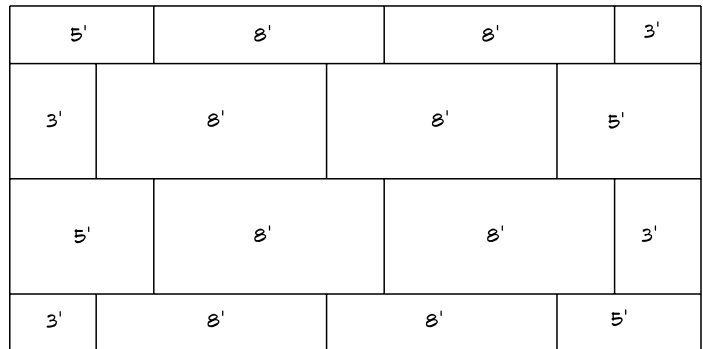

# 12 ROOF SHEATHING LAYOUT

SCALE: 0.1500" = 1'-0"